

USERS MANUAL & SAFETY GUIDE

Thoroughly read this manual before assembling or using scaffolding unit. Failure to do so can result in **injury or death.** Seriously... **read it.**

One Year Warranty

This product is guaranteed for one year against flaws in materials and craftsmanship

SAFETY GUIDE AND BOX CONTENTS



Read Before Use

Thoroughly read this manual before assembling or using scaffolding unit.



Electrical Warning

Never use scaffolding unit in proximity to live electrical circuits or power lines.

Prior to Use

- ▶ Only use scaffold unit while complying with local, state, and national guidelines. Refrain from using scaffolding if you are unwell, taking medication, consuming alcohol, mind-altering drugs or experiencing any other condition that may impair your ability to work.
- ▶ Only use scaffold unit as intended while complying with local, state, and national guidelines and legislation.
- ▶ DO NOT stack more than two units.
- ▶ A competent person should inspect scaffolding before every use.
- ▶ Manually inspect scaffolding prior to use, ensuring that casters, siderails, and platform properly locked as well as that any additional components are secured with proper fasteners.
- ▶ Do not use scaffolding or outriggers if any parts are damaged or missing.
- ▶ Before stacking scaffold units, a set of (4) outriggers with casters must be securely installed on the base section of scaffolding and guardrails must be in use.
- ▶ Outriggers must be tight against end frames and casters must be in contact with a solid, level surface.
- ▶ Keep body as close to ladder as possible when climbing. This helps prevent tipping.
- ▶ Safety guardrail system must be installed on all sides of scaffold platform where a fall from a height of 6 ft (1.8 m) or greater may occur.
- ▶ Always secure guardrail system to the structure using span pins before use.
- ▶ Manually inspect scaffolding prior to use, ensuring that casters, siderails, and platform properly locked as well as that any additional components are secured with proper fasteners.
- ▶ Two side rails must be installed on each level defined by one 6' multifunction unit and spaced evenly throughout the scaffold. Scaffold collapse is possible with uneven placement and could result in injury or death.
- ▶ Secure casters in frames with span pins before use.
- ▶ Never climb until all casters are locked. This includes locking the caster on outriggers as well as those in the scaffold frames.
- ▶ Only use on level, even surfaces. Avoid using scaffold on surfaces that are soft, muddy, debris filled, holey or otherwise obstructed.

- ▶ Only use ScaffoldMart caster jacks to adjust height of casters. Never attach any other material to extend leg of unit. Do not increase height of scaffold units by any means other than utilizing manufacturer parts designated for that purpose.
- ▶ Acids are corrosive and exposure diminishes the integrity of scaffold unit. Do not expose to corrosive materials.
- ▶ Keep scaffold free of clutter and unnecessary equipment to avoid tripping while in use.
- ▶ Keep body centered inside structure of scaffold to avoid tipping.
- ▶ Remove or fasten all tools, material, or equipment before moving scaffolding. Never move scaffold while a person is on unit. Be careful when moving unit to avoid tipping.

BOX CONTENTS

**Stability Braces: quantity 2
(left and right)**

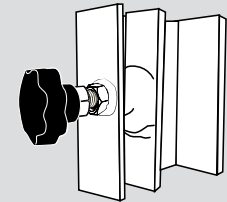
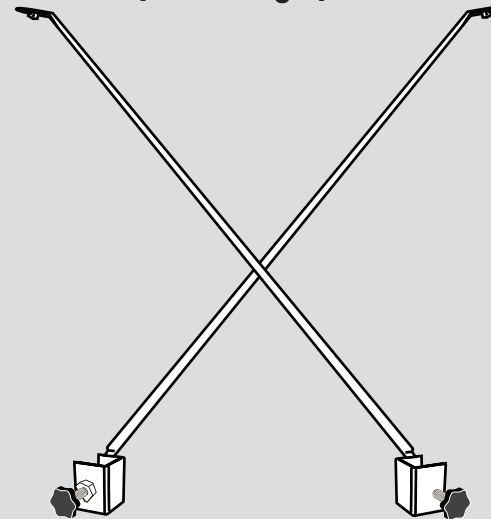

**Rail Clamps:
quantity 4**

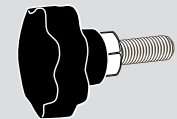

**Tightening Knob:
quantity 4**

STABILITY KIT INSTRUCTIONS



Set up the 6' Multifunction Unit by following the instruction manual supplied with your unit before installing the stability kit.

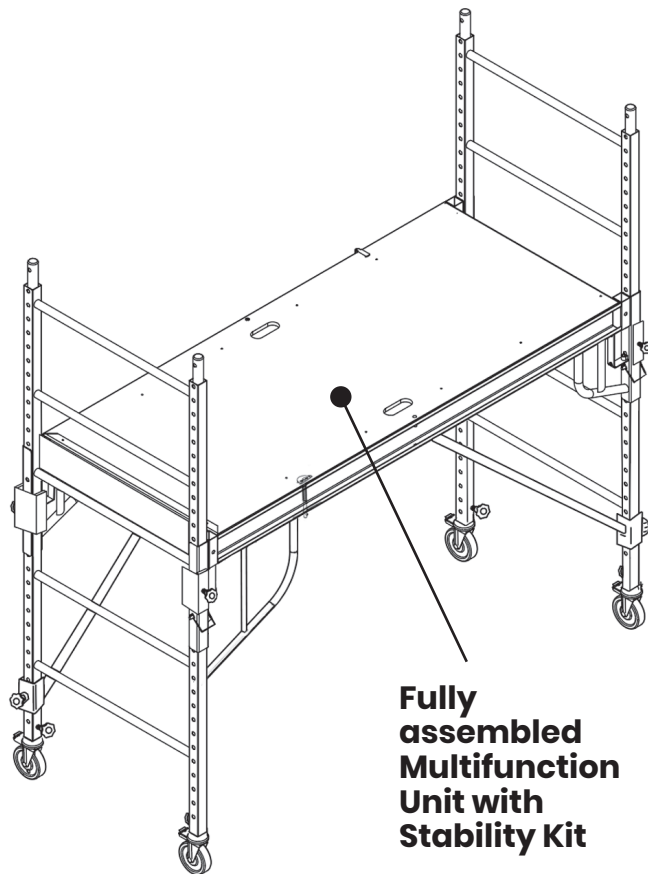

**Fully
assembled
Multifunction
Unit with
Stability Kit**

APPLYING STABILITY BRACES

1

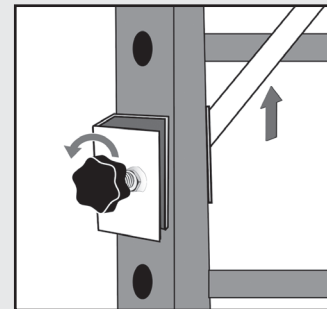

A. Loosely secure clamp around square frame tube, with brace extending up and inward of frames.

2

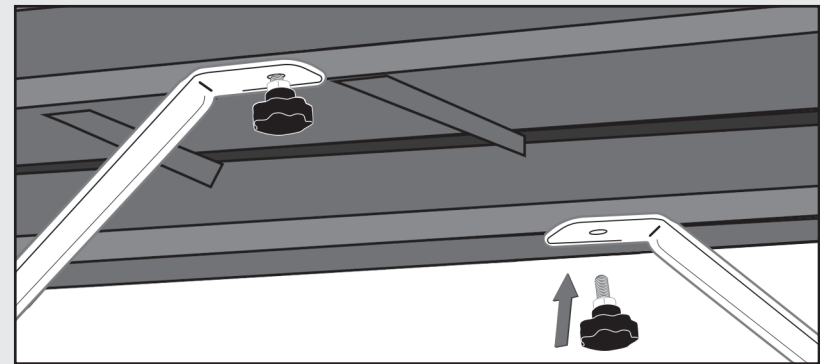

- B.** Raise the brace until the high end reaches the multifunction siderail.
- C.** Secure the high end by screwing knob through brace, into the receiver at the middle of the rail, underside.
- D.** Tighten both knobs until hand tight, then a quarter-turn.

CONTACT US: 1-866-900-0983 | customerservicescaffoldmart.com



Set up the 6' Multifunction Unit by following the instruction manual supplied with your unit before installing the stability kit.

APPLYING RAIL CLAMPS

3

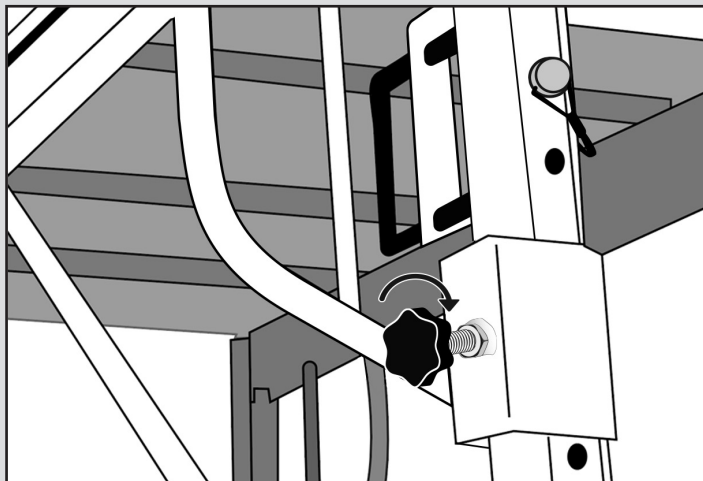

- A. Apply rail clamp around siderail bracket and frame tube.
- B. Place it just below the pull-handle that secures siderail to frame.
- C. It should be set such that when tightened, it presses the frame into the siderail, reinforcing the connection.
- D. Turn until hand-tight, then a quarter turn more.

APPLYING CASTER LOCKS

4

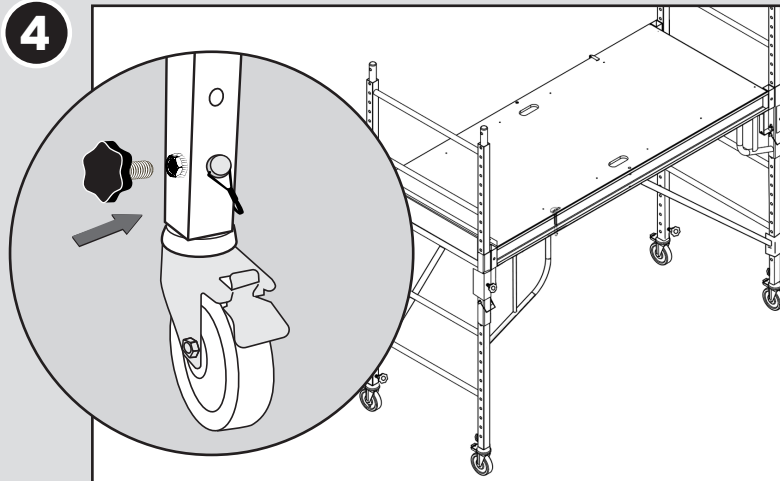

- A. Caster locks must be used in conjunction with span pins.
- B. After securing wheels in 6' Multifunction Unit with span pins, apply caster locks in nuts at base of frame legs, perpendicular to the span pin.
- C. Turn until hand-tight, then a quarter turn more.



Always check each knob prior to using scaffolding. Make certain that the knobs are making direct contact with steel on caster stem, not extending inside the stem through the hole in it's side the way a span pin would.



ScaffoldMart
.com

Sales Office: 1705 South Evans St. | Greenville, NC 27834 | **Warehouse Address:** 1002 North Pitt St. | Greenville, NC 27834

Phone: (866) 900-0983 | **Fax:** (252) 756-3849